

BHBCON INSTALLATION INSTRUCTIONS SINGLE TRUSS CONNECTION TO CONCRETE

- 1** Install assembled BHBCON bracket to the top of the ICF wall.

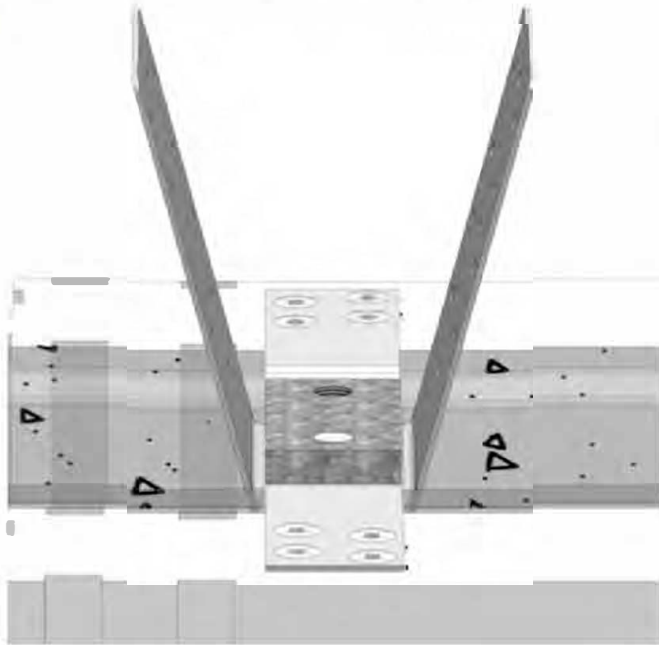

| ALLOWABLE LOADS (LB) - ASD | |
|----------------------------|-------------|
| Vertical | Lateral |
| 3105 | 1552 |

- 2** Place truss inside BHBCON.
- 3** Fix Truss to BHBCON with 4 screws each side. Use 5 screws for higher tie down requirements.

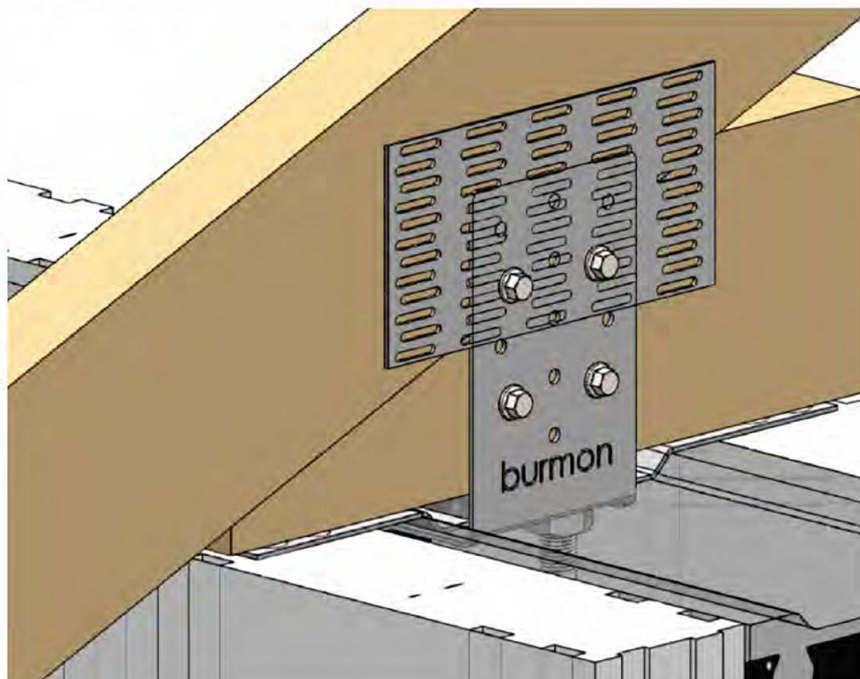

BHBCON INSTALLATION INSTRUCTIONS GIRDER TRUSS TO CONCRETE CONNECTION USING 2 BHBCON

1 Install assembled BHBCON bracket to the top of the ICF wall.

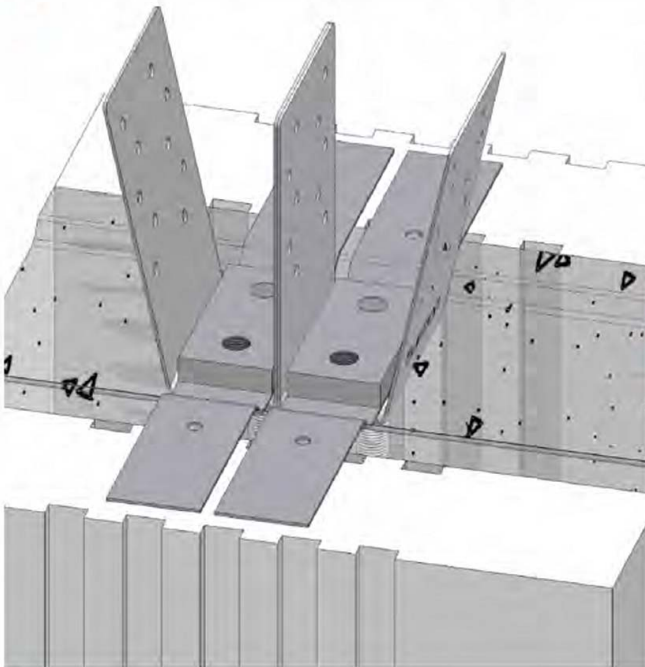

ALLOWABLE LOADS (LB) - ASD

| Vertical | Lateral |
|----------|---------|
| 3105 | 1552 |

2 Place truss inside BHBCON.

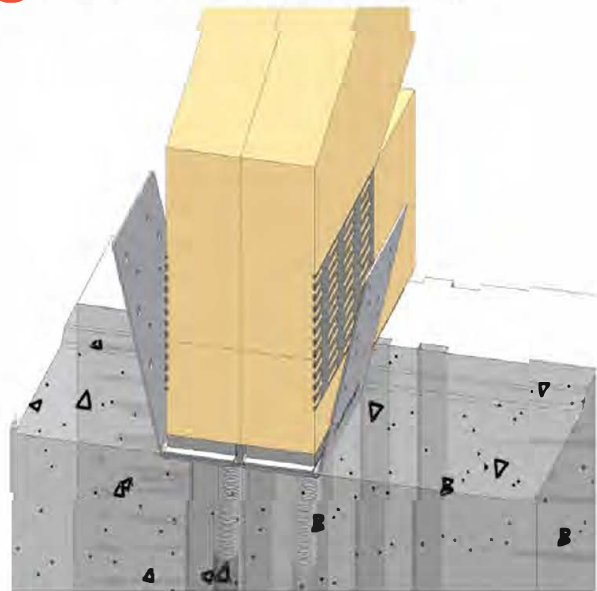

3 Fix Truss to BHBCON with 4 screws each side.

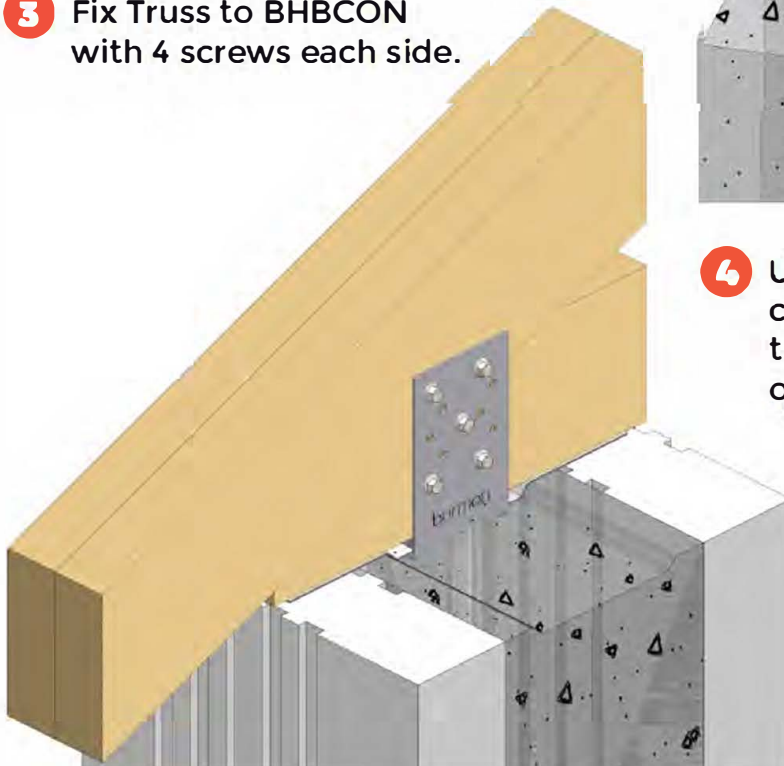

4 Using a 3-inch, 12 gauge construction screw, drive screw through BHBCON and Trusses, one each side as shown.

BHBCON INSTALLATION INSTRUCTIONS GIRDER TRUSS TO CONCRETE CONNECTION USING 1 BHBCON

- 1** Install one BHBCON bracket to top of ICF wall. Ensure inner wall of BHBCON is vertical. Fix truss to the outer side of BHBCON with 5 screws supplied.

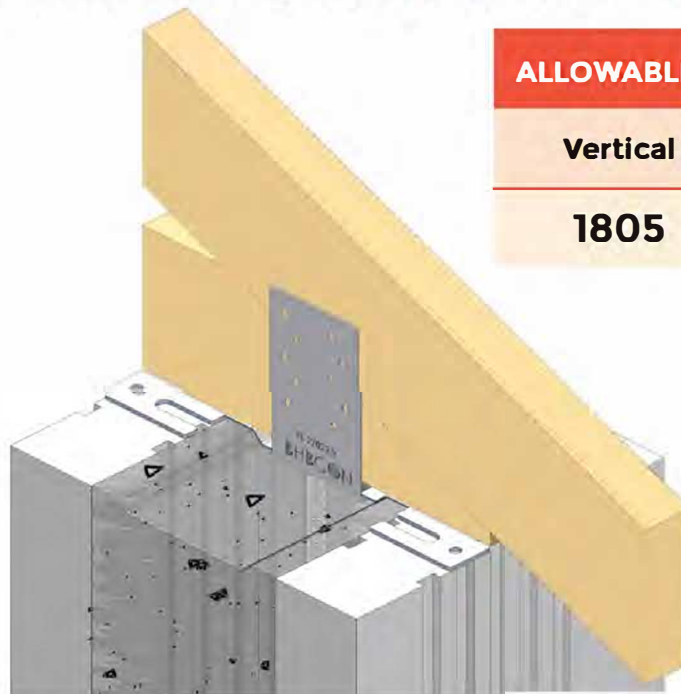

| ALLOWABLE LOADS (LB) - ASD | |
|----------------------------|---------|
| Vertical | Lateral |
| 1805 | 1200 |

- 3** Use a packer to make level and position the second truss alongside BHBCON. Fix truss to BHBCON using 5 x 3-inch x 12 gauge construction screws as shown.

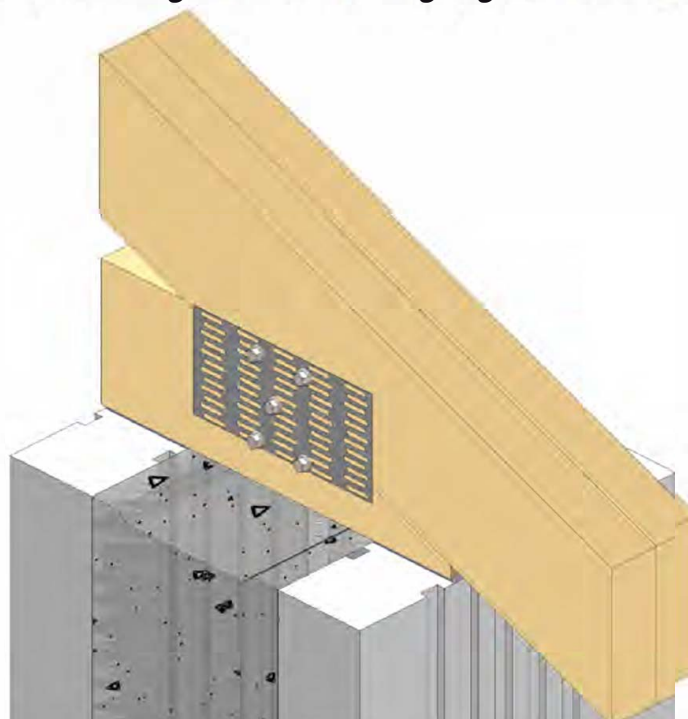

BHBCON INSTALLATION INSTRUCTIONS GABLE END CONNECTION

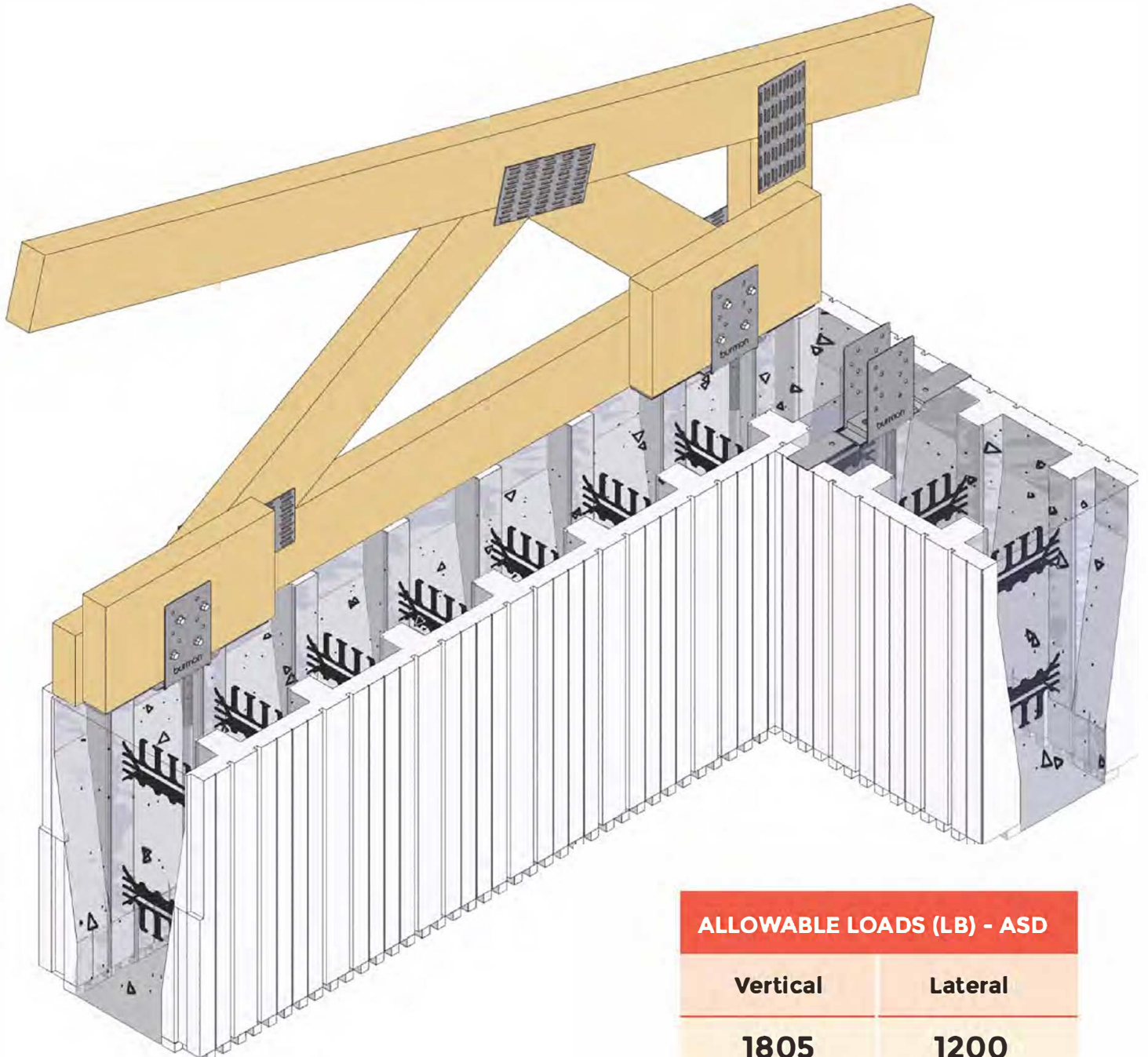

| ALLOWABLE LOADS (LB) - ASD | |
|----------------------------|---------|
| Vertical | Lateral |
| 1805 | 1200 |

- 1** Position BHBCON in ICF Block as shown. If Taper edge block is not available, cut foam of standard block so BHBCON sits in position as shown.

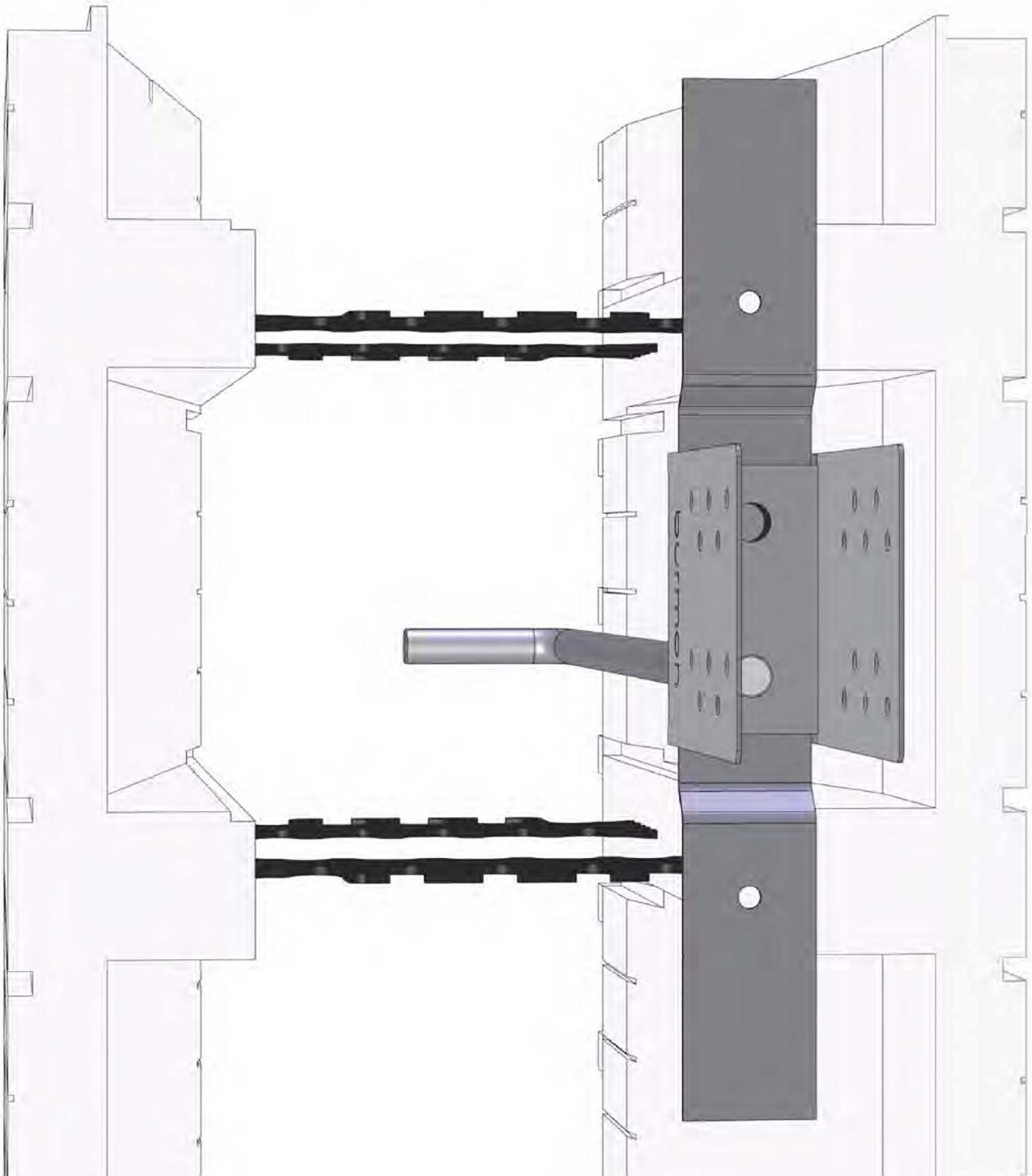

- 2** Place a 2 x 6 inside BHBCON and fix with (4) hex head screws to near side as shown.



2 (continued) Side View

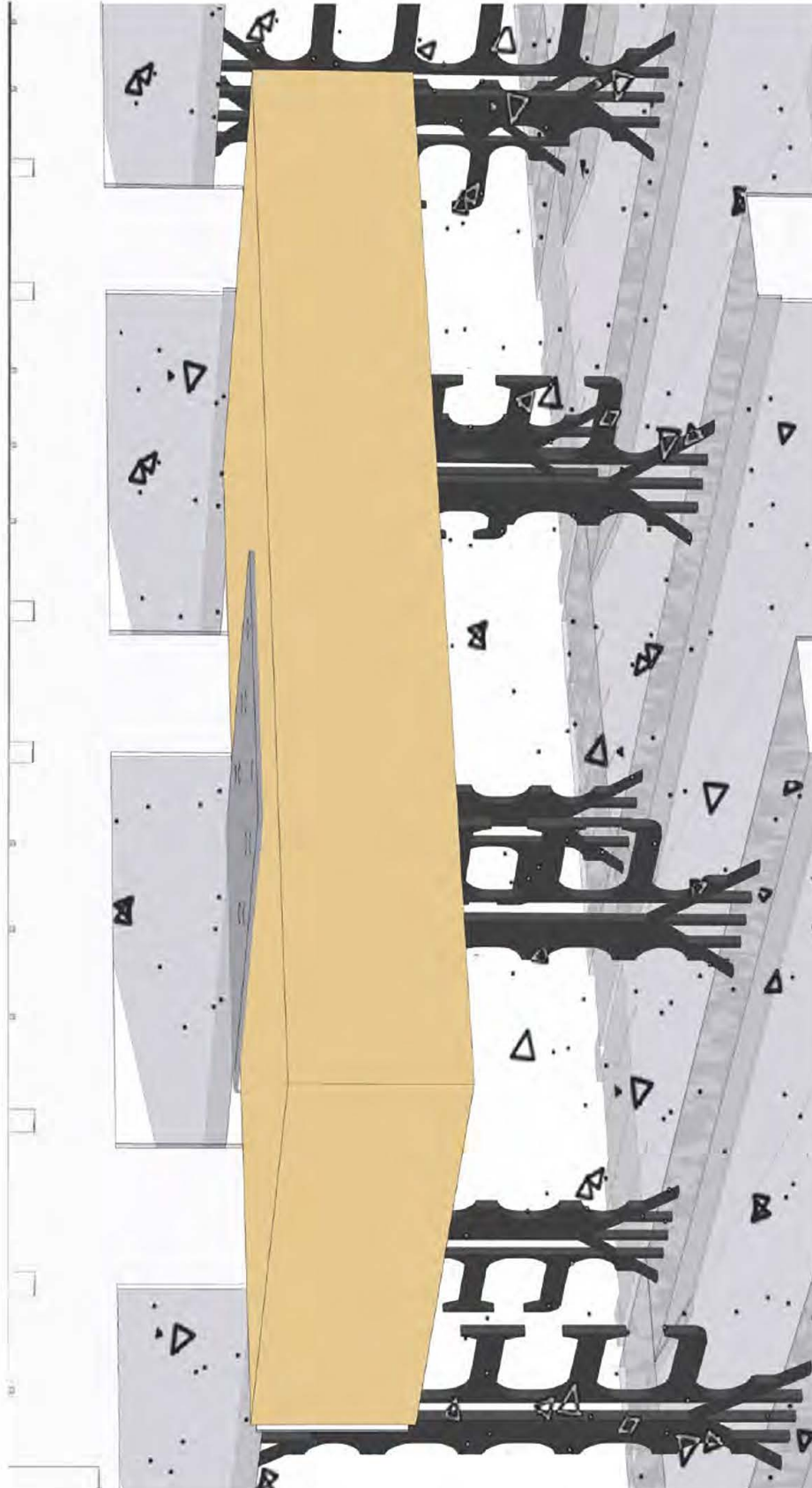

2 (continued) View showing 2 BHBCON connections

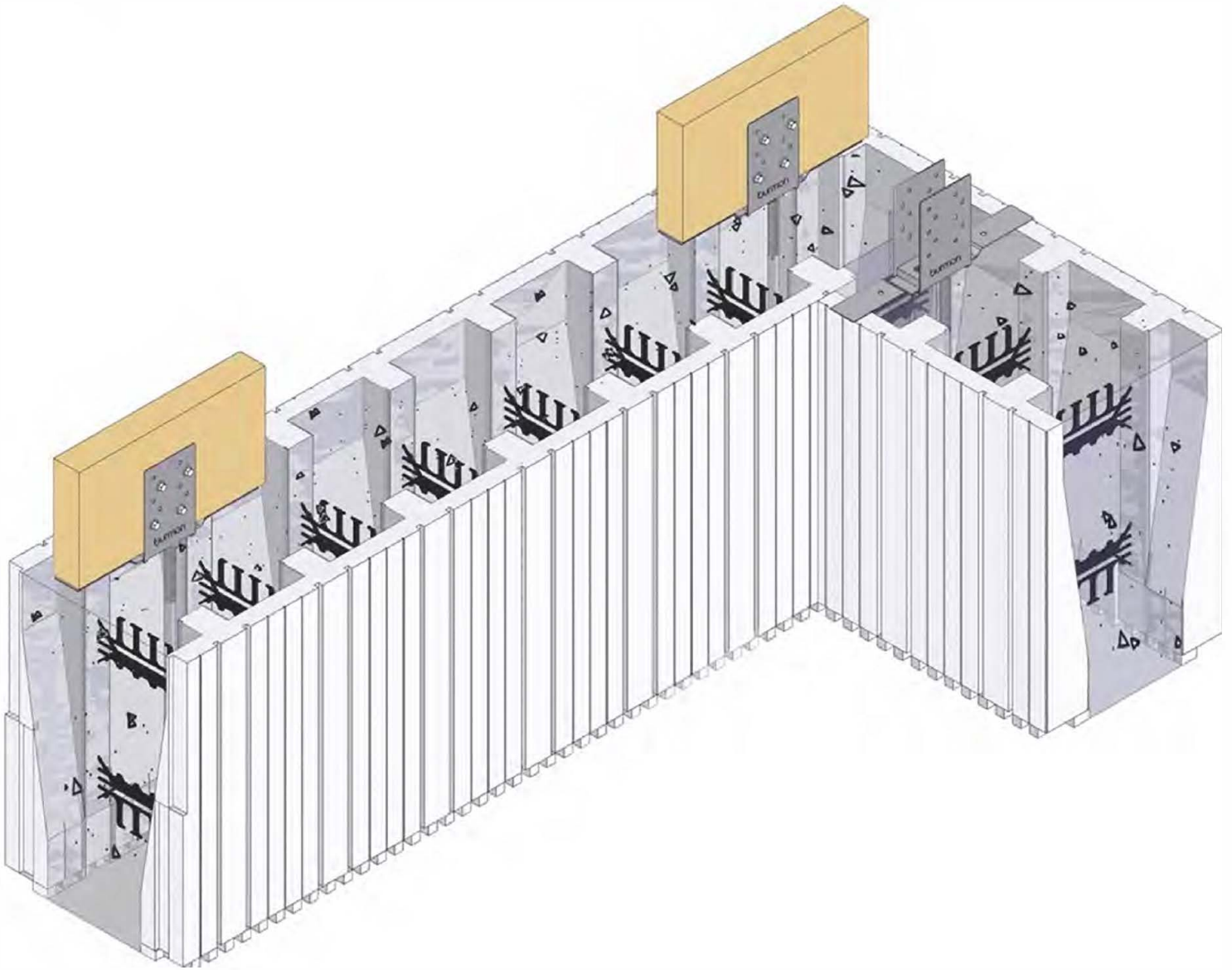

- 3** Fix Truss to BHBCON using (4) Burmon 2½ inch screws by screwing truss, BHBCON and 2 x 6 together as one piece.



3 (continued) Front View

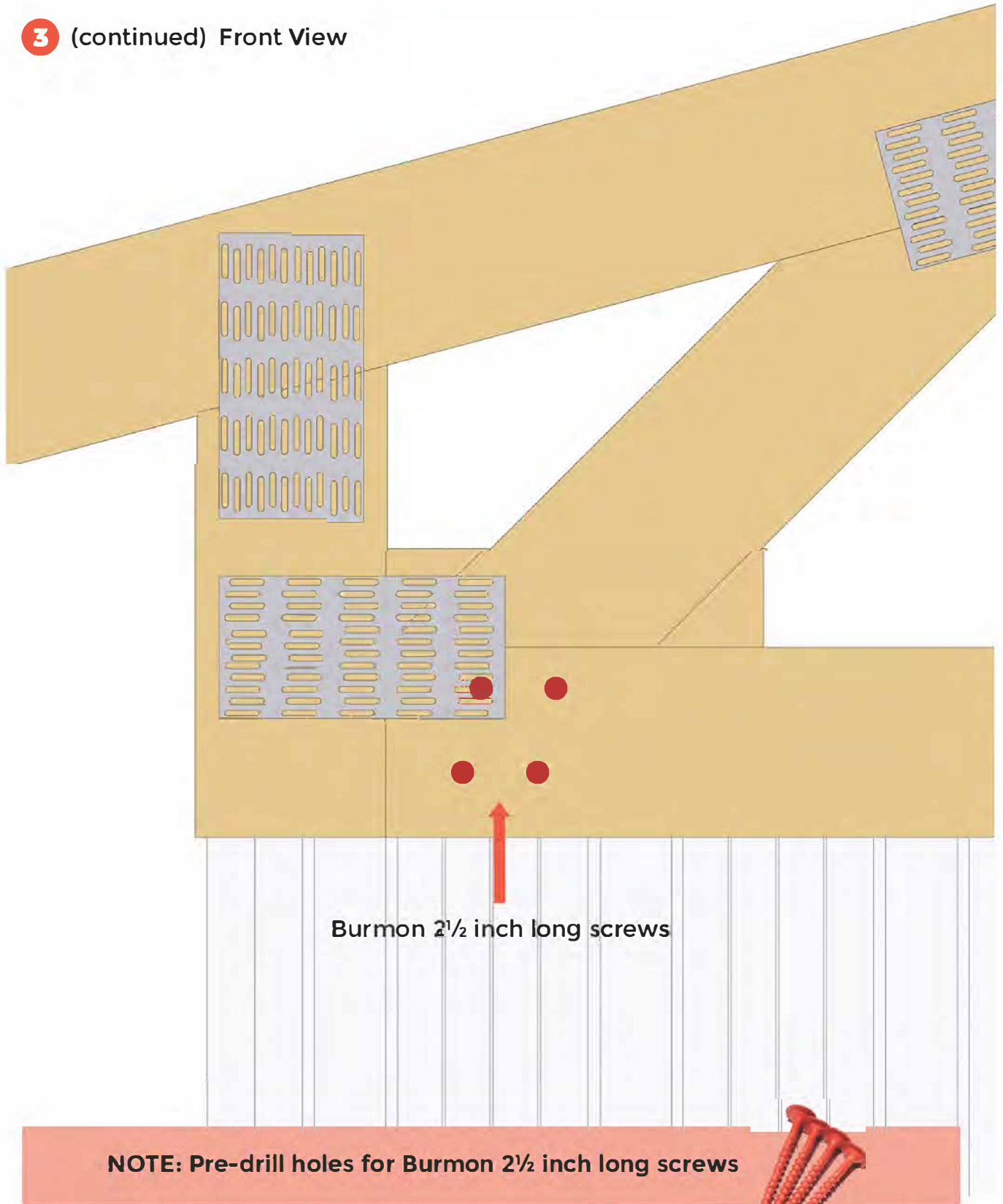

NOTE: Pre-drill holes for Burmon 2 1/2 inch long screws

